

# SHC GREEN INFRASTRUCTURE

1000 Eliot Street  
Detroit, MI 48207

January 9, 2020  
RECORD DRAWINGS

SmithGroup Project Number: 10756.000

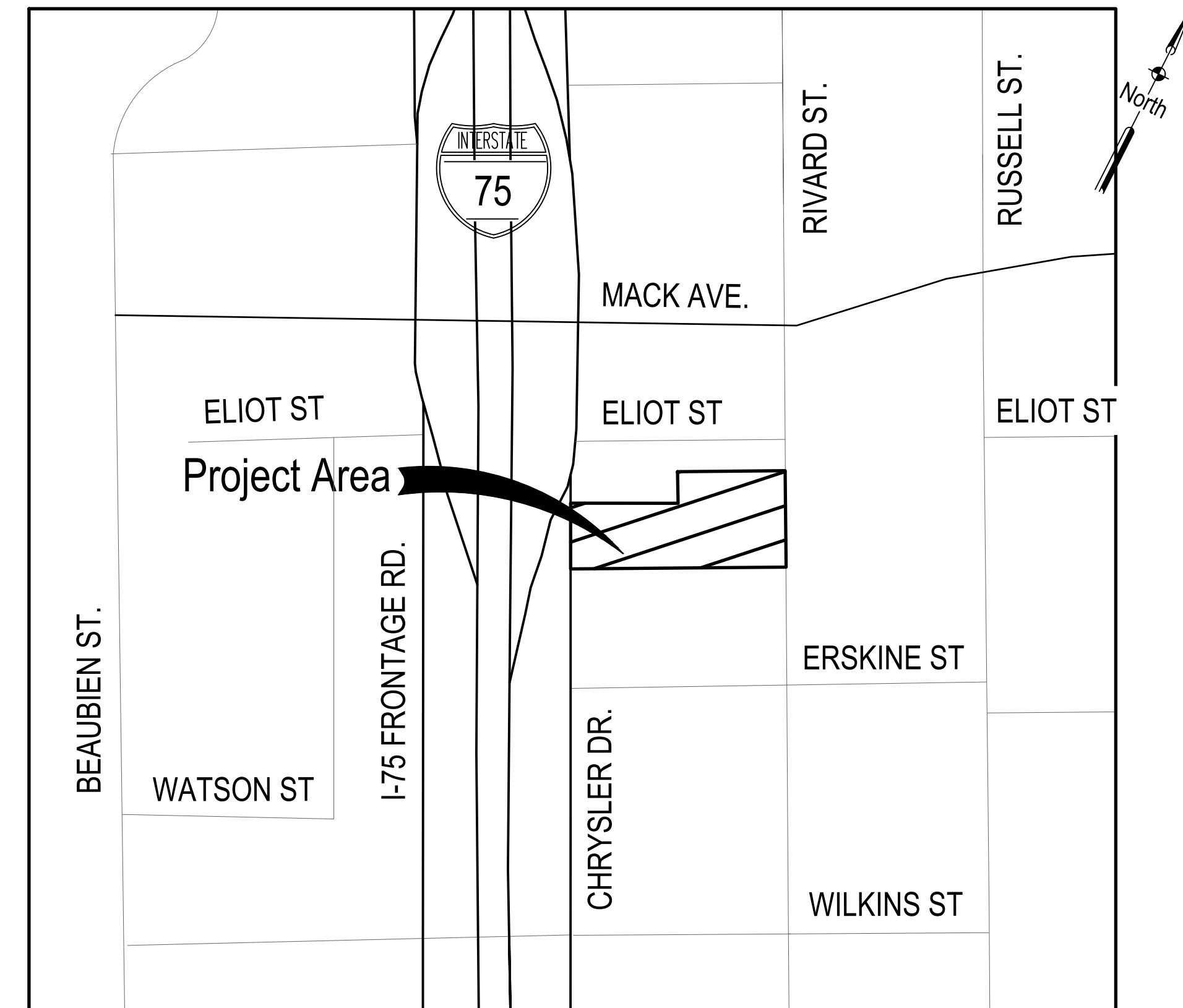

PROJECT VICINITY MAP

Sheet List Table	
Sheet Number	Sheet Title
COVER	COVER SHEET
C-100	SURVEY AND EXISTING CONDITIONS
C-200	DEMOLITION, EROSION & SEDIMENT CONTROL PLAN
C-201	SITE PREPARATION & SESC DETAILS
C-300	LAYOUT PLAN
C-301	BIORETENTION CROSS SECTIONS
C-302	PAVEMENT DETAILS 1
C-400	GRADING PLAN
C-500	UTILITY PLAN
C-501	UTILITY PROFILES
C-502	UTILITY DETAILS
L-100	PLANTING PLAN & DETAILS
L-101	PLANTING PLAN ENLARGEMENTS & PLANT LIST

**Prepared for:**

The Nature Conservancy  
4219 Woodward Avenue  
Suite 302  
Detroit, Michigan 48201

**Owner:**

Archdiocese of Detroit  
4311 Central St.  
Detroit, MI 48210

**Prepared by:**

**SMITHGROUP**

201 DEPOT STREET  
SECOND FLOOR  
ANN ARBOR, MI 48104  
734.662.4457  
www.smithgroup.com

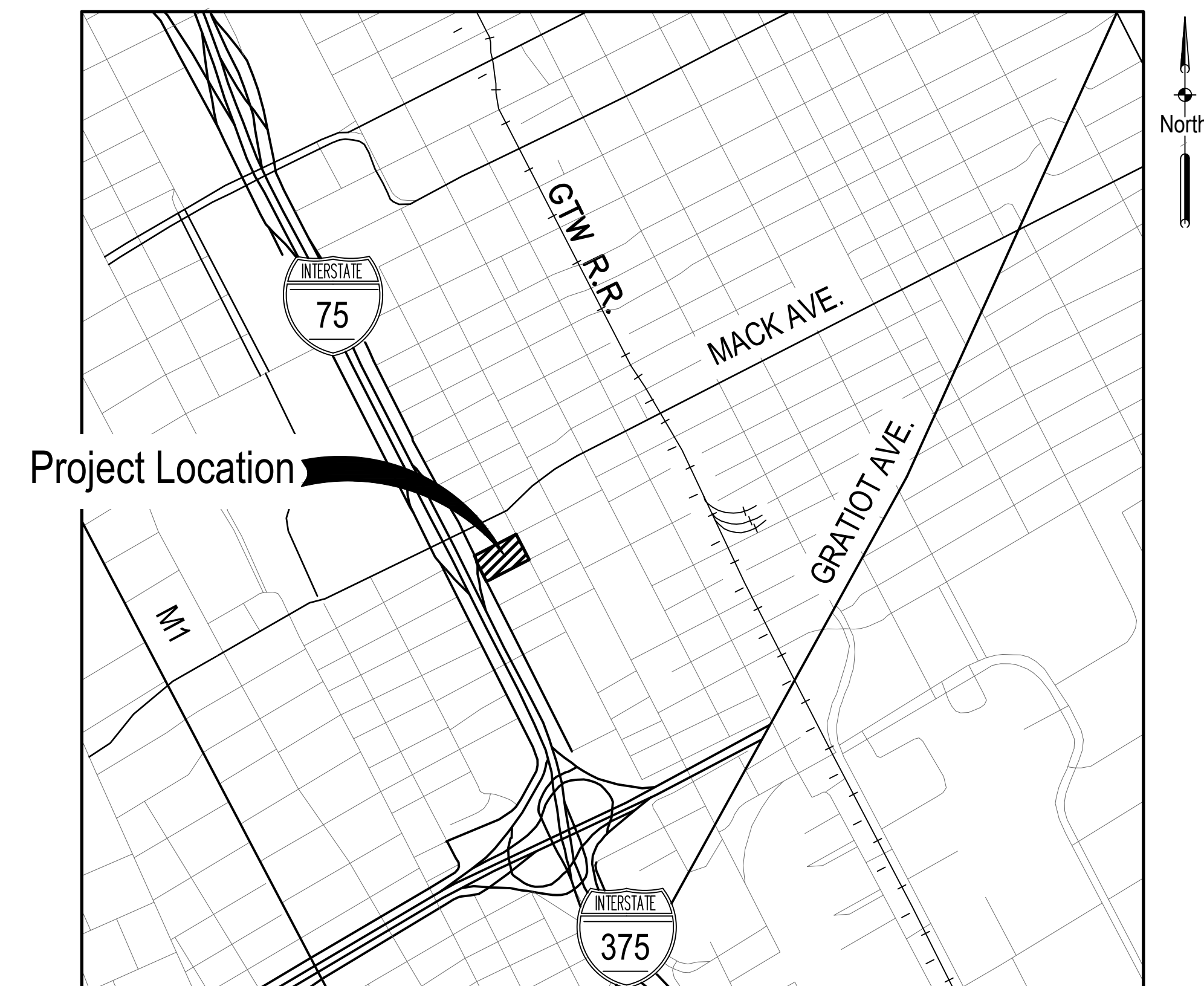

PROJECT LOCATION MAP

RECORD DRAWINGS HAVE BEEN PREPARED BASED ON ISSUED BULLETINS, SKETCHES, RFI RESPONSES PROVIDED TO CONTRACTOR DURING CONSTRUCTION IN ADDITION TO CONTRACTOR'S RED-LINED SET OF CONSTRUCTION DOCUMENTS. ALL ELEVATIONS AND DIMENSIONS ARE PROPOSED DESIGN ELEVATIONS AND DIMENSIONS. AN AS-BUILT SURVEY WAS NOT PERFORMED.



VICINITY SKETCH -  
SHC, CITY OF DETROIT, MICHIGAN

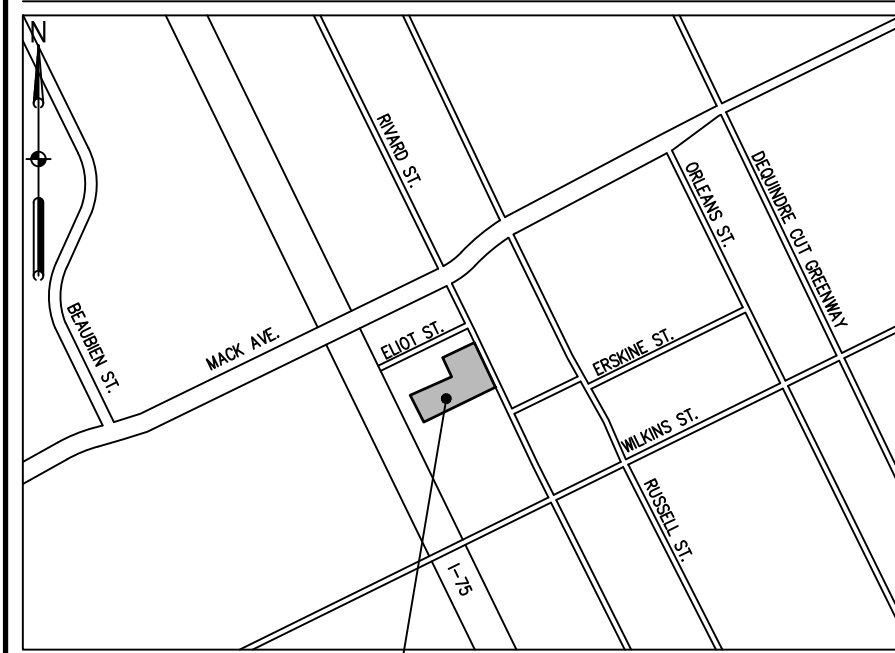

PROJECT SITE

SOURCE BENCHMARK

SITE BM #5  
SPALDING DEDECKER & ASSOCIATES SURVEY (JOB SM08-043)  
DATED 9-14-2012. SCRIBED "X" ON SOUTHEAST CORNER OF  
TRANSFORMER PAD AT NORTHWEST CORNER OF MARKET AND  
ADELAIDE.

NORTHING = 311,502.68  
EASTING = 13,482,052.16  
ELEVATION = 142.58 FEET (CDD\*)

\* SEE NOTE 2 IN SURVEYOR'S NOTES BELOW

SURVEY LEGEND

BM #1	BENCHMARK
CP 1	CONTROL POINT
F	FOUND IRON BAR OR PIPE
700.00	SPOT ELEVATION
700.00	TOP OF CURB ELEVATION
700.00	GUTTER ELEVATION
700.00	EDGE OF METAL ELEVATION
700.00	CURB CUT ELEVATION
703.00	TOP OF WALL ELEVATION
702.00	BOTTOM OF WALL ELEVATION
705.00	FINISH FLOOR ELEVATION
	TREE - DECIDUOUS
	TREE - CONIFEROUS
	BUSH - DECIDUOUS
	BUSH - CONIFEROUS
	STUMP
	MISC. POINT
	AIR CONDITIONER
	HEATING/COOLING UNIT (HVAC)
	END OF UTILITY NOT KNOWN/SHOWN
	TOPOGRAPHIC CONTOUR
	SIGN
	US MAIL DROPBOX
	MEMORIAL PLAQUE OR STONE
	BOLLARD OR POST
	PAVEMENT MARKING - ADA PARKING
	FLOODLIGHT
	CATCH BASIN (ROUND)
	CATCH BASIN (BEHIVE)
	CATCH BASIN (SQUARE)
	CURB INLET
	STORM MANHOLE
	SANITARY MANHOLE
	LIGHTING MANHOLE
	ELECTRIC MANHOLE
	GAS MANHOLE
	COMMUNICATIONS MANHOLE
	WATER MANHOLE
	DOWNSPOUT
	VENT OR CLEANOUT
	BUILDING PERMETER
	BUILDING ROOF OVERHANG
	ELECTRIC TRANSFORMER
	CABLE OR TELECOM RISER
	UTILITY POLE
	GUY WIRE
	LIGHT POLE OR LAMP POST
	TRAFFIC SIGNAL POLE (TSP)
	TSP WITH CROSSWALK SIGNAL
	CROSSWALK SIGNAL POST
	ADA DETECTABLE WARNING MAT
	FIRE HYDRANT
	WATER SHUT OFF VALVE
	FIRE DEPT. CONNECTION
	IRRIGATION CONTROL VALVE
	GAS SHUT OFF VALVE
	ELECTRIC OR GAS METER
	HANDHOLE CABLE
	HANDHOLE ELECTRIC
	HANDHOLE FIBER OPTIC
	HANDHOLE LIGHTING
	HANDHOLE SIGNALIZATION
	HANDHOLE TELECOM
	FENCE LINE
	HANDRAIL
	QUADRANT
	UNDERGROUND TELECOMMUNICATION
	UNDERGROUND ELECTRIC
	FIBER OPTIC
	CABLE TELEVISION
	NATURAL GAS
	NATURAL GAS (ABANDONED)
	OVERHEAD UTILITY
	SANITARY SEWER
	STORM SEWER
	WATER MAIN
	WATER MAIN (ABANDONED)
	HOT WATER (STEAM) LINE
	FIRE SUPPRESSION
	PUBLIC LIGHTING - UNDERGROUND
	PUBLIC LIGHTING - OVERHEAD

# LIMITED TOPOGRAPHIC SURVEY

PART OF "PLAT OF CONNOR'S SUB'N OF THE NORTH HALF OF OUTLOT  
185, RIVARD FARM" AS RECORDED IN L.3 OF PLATS, P.82, W.C.R., CITY  
OF DETROIT, WAYNE COUNTY, MICHIGAN

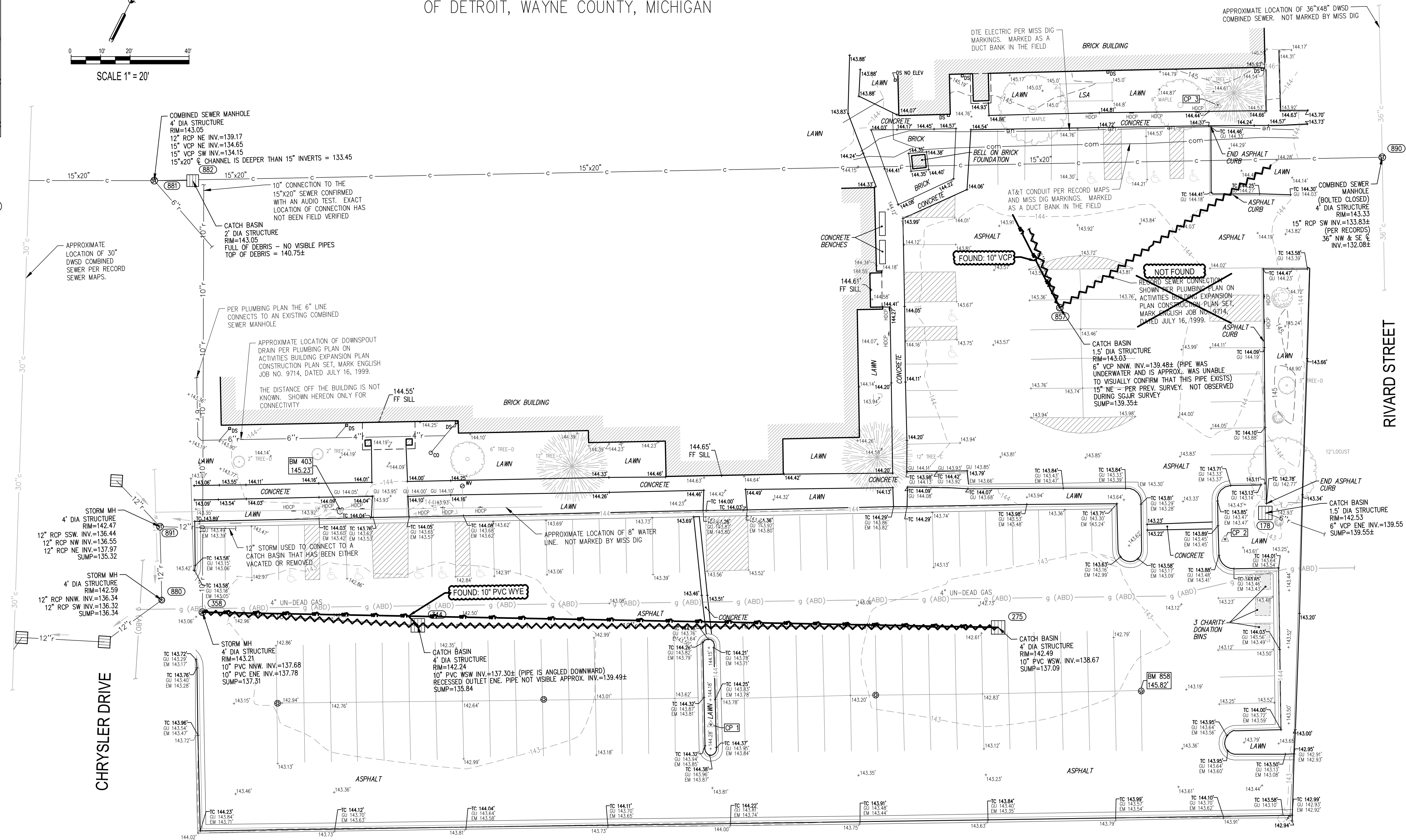

## SURVEYOR'S NOTES

- HORIZONTAL DATUM IS ACCORDING TO MICHIGAN STATE PLANE GRID COORDINATES, SOUTH ZONE (2113), GEOID 2012A, INTERNATIONAL FEET AS LINEAR UNIT OF MEASURE.
- VERTICAL DATUM IS THE CITY OF DETROIT (CDD) DATUM, AS ESTABLISHED ON A SURVEY BY SPALDING DEDECKER & ASSOCIATES (JOB SM08-043), DATED 09-14-2012, WITH SOURCE BENCHMARK LISTED HEREON. TO CONVERT FROM CDD DATUM TO NORTH AMERICAN VERTICAL DATUM OF 1988 (NAVD88):  
CDD + 479.31 FEET = NAVD88
- SMITHGROUP PERFORMED A TOPOGRAPHIC SURVEY UTILIZING DATA COLLECTED WITH GLOBAL POSITIONING RECEIVERS REFERENCING THE MICHIGAN CONTINUOUSLY OPERATING REFERENCE NETWORK FOR SITE CONTROL AND DATA COLLECTION. ROBOTIC TOTAL STATIONS WERE ALSO USED FOR DATA COLLECTION. DATA WAS COLLECTED IN THE FIELD ON MAY 22, 2018. THE LIMITS OF THE SURVEY WERE RESTRICTED TO THE AREAS SHOWN HEREON. PUBLIC RIGHTS-OF-WAY WERE EXCLUDED FROM THE MAPPING EFFORT.
- THIS SURVEY DOES NOT CONSTITUTE A TITLE SEARCH BY THE SURVEYOR. ALL INFORMATION REGARDING LAND BOUNDARY, EASEMENTS, RIGHTS-OF-WAY, AND OTHER INFORMATION THAT MAY AFFECT TITLE WAS GAINED FROM AVAILABLE TAX RECORDS AND/OR RECORDED LEGAL DOCUMENTS FOR ADJOINING PARCELS. A BOUNDARY SURVEY WAS NOT INCLUDED AS PART OF THE SCOPE OF SERVICES
- MISS-DIG DESIGN TICKET B081380929-00B WAS ISSUED FOR THIS PROJECT. AS OF THE DATE OF THIS SURVEY THE FOLLOWING UTILITY OWNERS HAVE PROVIDED RECORD MAPS OR RESPONDED THAT THEY DO NOT HAVE ASSETS IN THE PROJECT AREA:
  - AT&T (TELECOM)
  - DTE (GAS)
  - SPRINT/NEXTEL (TELECOM)
  - COMCAST (TELECOM)
  - ITC (POWER)
  - DTE (ELECTRIC)
- UNDERGROUND UTILITY LOCATIONS WERE DERIVED FROM ACTUAL MEASUREMENTS ON VISIBLE UTILITIES, MISS-DIG FLAGS/MARKINGS, AND/OR AVAILABLE RECORDS. THEY SHOULD NOT BE INTERPRETED TO BE EXACT LOCATIONS, NOR SHOULD THEY BE ASSUMED THAT THEY ARE THE ONLY UNDERGROUND UTILITIES IN THE AREA. MISS DIG STAKING TICKET NO. B81380908 WAS ISSUED FOR THIS PROJECT.
- SUBSURFACE AND ENVIRONMENTAL CONDITIONS WERE NOT EXAMINED AND ARE NOT CONSIDERED A PART OF THIS SURVEY. NO STATEMENT IS MADE CONCERNING THE EXISTENCE OF UNDERGROUND OR OVERHEAD CONTAINERS OR FACILITIES THAT MAY AFFECT THE USE AND OR DEVELOPMENT OF THIS SITE.
- ADDITIONAL SPOT ELEVATIONS MAY BE CONTAINED IN THE PROJECT DATABASE, AND ALTHOUGH NOT APPEARING IN THE RECORD PLAN DOCUMENT DUE TO SCALE AND VISIBILITY, WERE UTILIZED IN THE DIGITAL TERRAIN MODEL FOR CREATION OF THE ONE-FOOT CONTOURS. THE ADDITIONAL SPOT ELEVATION DATA IS AVAILABLE FOR FUTURE DESIGN ANALYSIS, BEING LOCATED ON A FROZEN LAYER WITHIN THE PROJECT DATABASE.

## CERTIFICATE

THIS IS TO CERTIFY THAT THIS MAP OR PLAT AND THE SURVEY ON WHICH IT IS BASED WERE MADE IN ACCORDANCE WITH LOCAL AND STATE JURISDICTIONAL REQUIREMENTS REGULATING MAPPING STANDARDS. THE UNDERSIGNED STATES THAT PROPER FIELD PROCEDURES, INSTRUMENTATION AND ADEQUATE STAFF WERE EMPLOYED TO ACHIEVE THE RESULTS INDICATED HEREIN.

SMITHGROUP, INC.

*Charles A. Langolf*  
CHARLES A. LANGOLF, PS 56210  
PROFESSIONAL SURVEYOR  
STATE OF MICHIGAN  
charles.langolf@smithgroup.com



3/20/19  
DATE:

## SHC GREEN INFRASTRUCTURE

1000 Eliot Street  
Detroit, MI 48207

Prepared For:  
**The Nature Conservancy**

Owner:  
**Archdiocese of Detroit**

## SMITHGROUP

201 DEPOT STREET  
SECOND FLOOR  
ANN ARBOR, MI 48104  
734.662.4457  
www.smithgroup.com

ISSUED FOR REV DATE

ADDL UTILITY MAPPING	1	8/30/18
ADDL UTILITY MAPPING	2	
RECORD DRAWINGS	3	3/20/19
		January 9, 2020

SEALS AND SIGNATURES

KEY PLAN



DRAWING TITLE  
**SURVEY AND EXISTING  
CONDITIONS**

SCALE 10756

PROJECT NUMBER

DRAWING NUMBER

# C-100











































